



SOUL ESTATES

SALES & LETTINGS

TO LET - 3 BEDROOM HOUSE

Bilston Road, Wolverhampton, WV2 2NN

£1,100 PCM

Soul Estates are proud to present this well presented 3 bedroom terraced house To Let. This perfect family home is situated in a very popular area of Wolverhampton. Situated near Priestfield Metro Station, with good schools, local amenities and transport links.

The property offers an entrance porch leading into the hallway further leading into the large through lounge, 25ft fitted kitchen with dining area, utility area housing the boiler and a ground floor family bathroom to the rear. Kitchen with a range of wall and base units to match, splashback tiling and a gas cooker and oven.

Stairs leading to the first-floor landing which leads off to, three good sized bedrooms and a shower room. The property also benefits from gas central heating, double glazing and a low maintenance rear garden.

✓ **3 BEDROOM TERRACED HOUSE**

✓ **LARGE THROUGH LOUNGE**

✓ **LARGE OPEN FITTED KITCHEN/DINER**

✓ **NEAR PRIESTFIELD METRO STATION**









SOUL ESTATES

SALES & LETTINGS

TO LET - 3 BEDROOM HOUSE

Bilston Road, Wolverhampton, WV2 2NN

£1,100 PCM

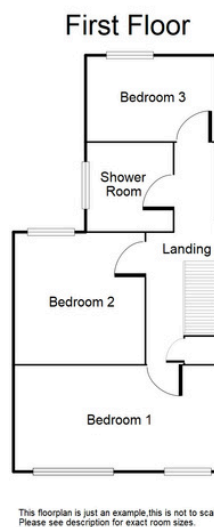
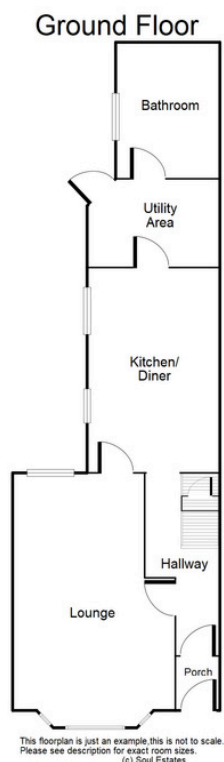

Entrance Porch

4' 4" x 2' 11" (1.32m x 0.89m)

Hallway

23' 2" x 2' 11" (7.06m x 0.89m)

Lounge

24' 2" x 11' 10" (7.36m x 3.60m)

Kitchen / Diner

25' 8" x 9' 4" (7.82m x 2.84m)

Utility Area

4' 7" x 9' 4" (1.40m x 2.84m)

Family Bathroom

9' 6" x 7' 2" (2.89m x 2.18m)

Landing

20' 5" x 2' 9" (6.22m x 0.84m)

Shower Room

5' 4" x 6' 3" (1.62m x 1.90m)

Bedroom 1

11' 10" x 15' 4" (3.60m x 4.67m)

Bedroom 2

12' 2" x 9' 6" (3.71m x 2.89m)

Bedroom 3

10' 1" x 9' 4" (3.07m x 2.84m)



SOUL ESTATES
SALES & LETTINGS

CONTACT US

Soul Estates
20 Great Bridge
Tipton
DY4 7HA

0121 647 6779

www.soulestates.co.uk

WWW.SOULESTATES.CO.UK | 0121 647 6779